

Z1000 DEEP SEAL TRAP

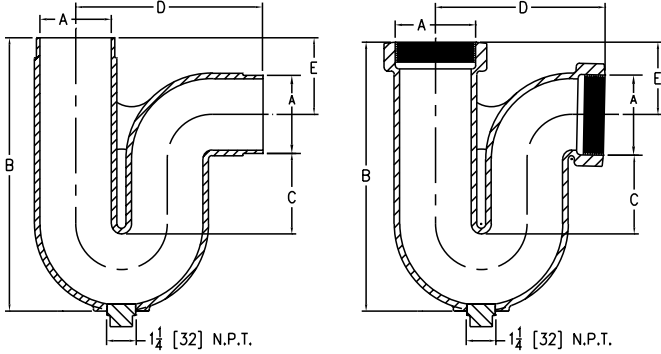

ENGINEERING SPECIFICATION

Zurn Z1000 deep seal trap features Dura-Coated cast iron body with bottom bronze cleanout plug.



BEST SELLERS	LIST PRICE
Z1000-3NH-P	823.00
Z1000-4NH	1,006.00

A Pipe Size/ Outlet Type	Dimensions in inches [mm]				Approximate Weight lb [kg]
	B	C	D	E	
Threaded (IP)					
2IP	9-1/2 [241]	4 [102]	5-7/8 [149]	1-3/4 [44]	8 [4]
3IP	13 [330]	5 [127]	7-1/2 [191]	3 [76]	17 [8]
4IP	15 [381]		9-1/2 [241]	4 [102]	32 [15]
No-Hub (NH)					
2NH	10-1/2 [267]	4 [102]	6-1/2 [165]	2-3/4 [70]	8 [4]
3NH	13-1/2 [343]	5 [127]	8 [203]	3-1/2 [89]	17 [8]
4NH	15-1/4 [387]		9-1/2 [241]	4-1/4 [108]	32 [15]

PREFIXES	DESCRIPTION	A PIPE SIZE	LIST PRICE
Z1000*	D.C.C.I. Body	2"	438.00
		3"	673.00
		4"	1,006.00

CONNECTION DESIGNATION (SPECIFY PIPE SIZE IN INCHES AND TYPE OF CONNECTION)		
CONNECTION TYPE	PIPE SIZE/OUTLET TYPE	ADD
IP	Threaded	2IP, 3IP, 4IP
NH	No-Hub	2NH, 3NH, 4NH
SUFFIXES	PIPE SIZE	ADD
-FL	Flushing Connection	150.00
-G	Galvanized Cast Iron	2" 3" 4"
-P	Trap Primer Connection (Specify 1/2" or 3/4")	150.00

Z1005 DEEP SEAL TRAP WITH ADJUSTABLE COVER



ENGINEERING SPECIFICATION

Zurn Z1005 deep seal trap features Dura-Coated cast iron body with no-hub inlet for use with bottom outlet drain, female threaded outlet connection with anchoring flange, and adjustable, floor level, gasketed, secured cast iron cover.

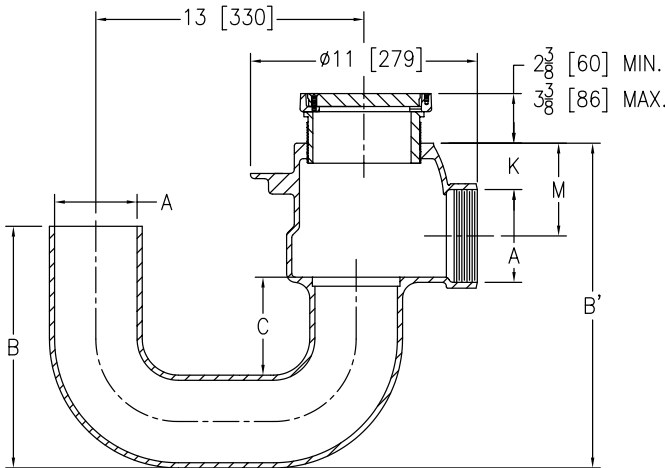

A Pipe Size/ Outlet Type	Dimensions in inches [mm]					Approximate Weight lb [kg]
	B	B'	C	K	M	
Threaded (IP)						
3IP	12-1/2 [318]	13-1/2 [343]	4-3/4 [121]	1-1/4 [32]	4 [102]	75 [34]
4IP	9-1/4 [235]	15-3/4 [400]	5 [127]	1-3/4 [44]	4-1/2 [114]	85 [39]

PREFIXES	DESCRIPTION	A PIPE SIZE	LIST PRICE
Z1005*	D.C.C.I. Body and Top	3" 4"	2,501.00 2,941.00
ZB1005	D.C.C.I. Body with Polished Scoriated Bronze Top	3" 4"	2,783.00 3,226.00
ZN1005	D.C.C.I. Body with Polished Scoriated Nickel Bronze Top	3" 4"	2,875.00 3,315.00

CONNECTION DESIGNATION (SPECIFY PIPE SIZE IN INCHES AND TYPE OF CONNECTION)		
CONNECTION TYPE	PIPE SIZE/OUTLET TYPE	ADD
IP	Threaded	3IP, 4IP
SUFFIXES	PIPE SIZE	ADD
-C	Clamping Collar	116.00
-G	Galvanized Cast Iron Body	977.00
-V	Backwater Valve	3" 4"
		724.00

For additional product information, please visit www.zurn.com

*Regularly furnished unless otherwise specified.

Items designated as Best Sellers are most specified and are generally in stock for shipment.

Ⓞ This symbol denotes a product that is engineered to reduce installation and rework time.